

# FPE-AT

# User Instructions



# User Instructions

These user instructions cover the following  
Branach products classified as for Professional use  
according to EN131-7:2013;

FPE-AT 0.9 to 2.0 All Terrain Platform Ladders

The owner of this platform ladder must ensure that these instructions are available to the user of the platform ladder.



The user of the platform ladder must refer to this instruction manual before using the platform ladder.



Indicates the maximum number of users allowed.



The platform ladder is suitable for Professional Use and Domestic Use.

This equipment should only be used by trained and competent person, otherwise the user should be under the direct supervision of a trained and competent person.

## 1. Before Use

- i. Ensure that you are fit enough to use a Branach safety step platform ladder.
- ii. Visually check the platform ladder, is not damaged and is safe to use at the start of each working day.
- iii. For professional and domestic users, regular periodic inspection is required.
- iv. Ensure platform ladder is suitable for the task.
- v. Do not use a damaged platform ladder.
- vi. Before using the platform ladder, the user should make themselves aware of the working at height regulations applicable to their location and working environment.

## 2. Inspecting the Branch Product Before Use



- i. Inspect the platform ladder after delivery.
- ii. Before every use visually check the platform is not damaged and is safe to use. If damaged, do not use.



- iii. The following items should be inspected as a minimum before using the system each day or after the platform is dropped or is impacted.

- Cracked or damaged Fiberglass Rails
- Damaged or missing Steps
- Damaged Feet
- Damaged Rope
- Check all brackets, rivets and bolts are in place
- Check platform ladder deck is operating freely
- Check that the entire platform ladder is free from contaminants such as dirt, oil, grease, paint, etc.
- Check the platform ladder inspection date has not been passed
- Check rear safety rail is operating correctly

**DO NOT USE THE PLATFORM LADDER  
IF ALL ITEMS HAVE NOT PASSED THE  
INSPECTION PROCESS**

### 3. Platform Ladder System Guidelines



- i. The maximum total load for the platform ladder is 150kg, including tools and equipment
- ii. System must always be deployed completely before use.
- iii. Deck must engage to rung.
- iv. TerrainMaster legs must always be deployed to their widest position allowing for 300mm +/- 15mm step height to ground.
- v. Before doing any work from the platform the rear safety rail must be engaged.

### 4. Positioning the Platform Ladder

- i. The platform ladder shall be fully extended with the rungs or treads level with the ground.
- ii. The platform ladder must be erected on a firm, unmovable surface with a maximum gradient of 15°.
- iii. When positioning the platform ladder, take into account the risk of collision with the platform ladder, e.g. from pedestrians, vehicles or doors.
- iv. Identify any electrical risks in the work area, such as overhead lines or other exposed electrical equipment.
- v. The platform ladder should be stood on both feet; not supported on the rungs or steps.
- vi. Platform ladders shall not be positioned on slippery surfaces (such as ice, shiny surfaces or significantly contaminated solid surfaces) unless additional effective measures are taken to prevent the platform ladder slipping or ensuring contaminated surfaces are sufficiently clean.
- vii. It is recommended that the platform ladder is positioned at the correct working angle.

## 5. Using the Platform Ladder

- Do not exceed the maximum total load for the platform ladder. Refer to the platform label.
- Do not overreach; both feet on the deck throughout the task.
- Always use with TerrainMaster feet in an opened position.
- Be especially cautious of wind when outside.
- Use non-conductive platform ladders for unavoidable live electrical work.
- Take precautions against children playing on the platform ladder.
- Face the platform ladder when ascending and descending.
- Keep a secure grip on the platform ladder when ascending and descending.
- At all times maintain 3 points of contact.
- Wear suitable foot wear when climbing a platform ladder.
- Avoid excessive side loadings e.g. drilling brick and concrete.
- Do not spend long periods on a platform ladder without breaks (fatigue is a serious risk).
- Equipment carried while using a platform ladder should be light and easy to handle.
- Do not move platform ladder when standing on it.
- Do not move platform ladder from top.

## 5. Using the Platform Ladder (continued)



Do not use the platform ladder on an unfirm or unstable base. Do not exceed the level the TerrainMaster can operate in (15° slope). Use the built-in level bubble or spirit level to ensure the platform ladder steps are level. If you are not sure, STOP. DO NOT RISK YOUR SAFETY.



Do not overreach. Keep both feet on the deck throughout the task.

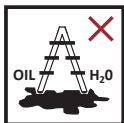

Do not erect platform ladder on heavily contaminated ground.

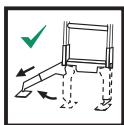

To ensure a level surface, use the bubble level in the TerrainMaster base..



Platform ladders with steps shall be used so that the steps are in a level horizontal position.



Ensure the deck has fully engaged the rung when lowering deck into position.

# FPE-AT Setup

## Ladder Glossary

- |                             |                          |
|-----------------------------|--------------------------|
| <b>A</b> Stiles             | <b>G</b> Handrail        |
| <b>B</b> Rungs              | <b>H</b> Brackets        |
| <b>C</b> Feet               | <b>I</b> Rods and Struts |
| <b>D</b> Platform Deck      | <b>J</b> Spacer          |
| <b>E</b> Platform Hooks     | <b>K</b> Step Plates     |
| <b>F</b> Platform Kickboard | <b>L</b> Rear Step       |
|                             | <b>M</b> Level Bubble    |

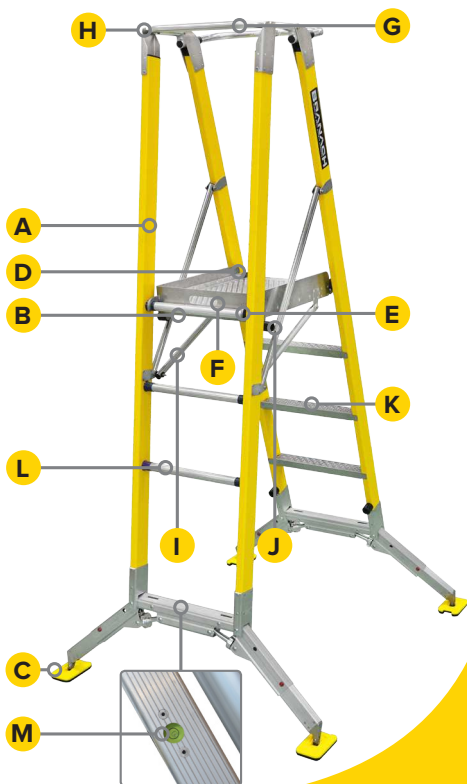

## 6. Initial Set Up

Take platform from vehicle and lay on the ground.



## 7. TerrainMaster Deployment

Slide the leg-lock latch towards the outside of the platform ladder.

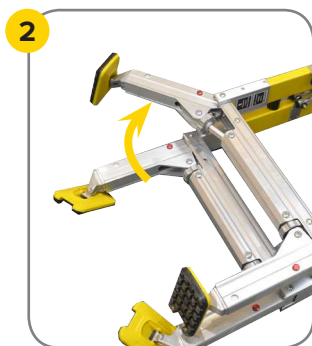
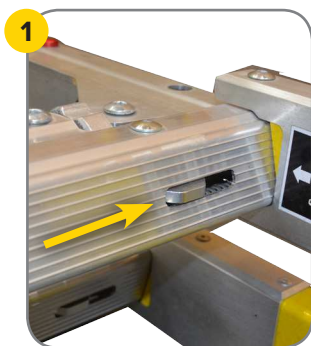



## 8. Extend TerrainMaster

- i. Extend the TerrainMaster legs to their widest setting.
- ii. Depress the front and rear leg buttons to extend the leg.
- iii. Check that the lock buttons re-engage in the extended leg position.

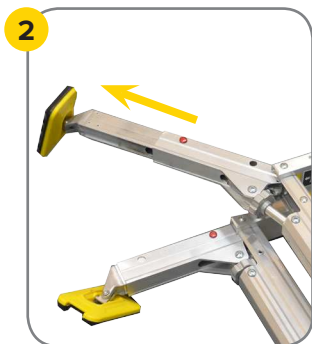
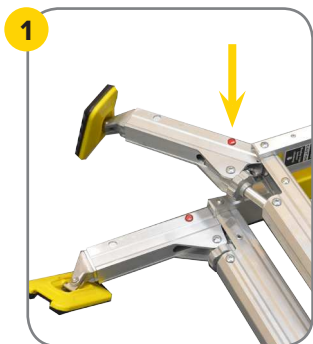

## 9. Opening Platform Ladder

1



Hold platform ladder upright facing the deck.

2



Place one hand on deck top and other on step cover.

3

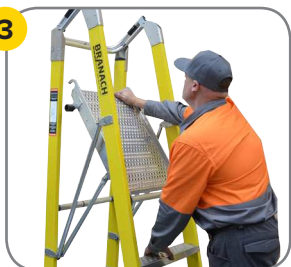

Push deck forward and allow platform ladder to move

4



Push platform ladder deck firmly down to engage hooks.

## 10. Levelling

- i. Adjust the TerrainMaster step height to be similar to step distance.
- ii. Un-weight the TerrainMaster leg to remove any spring tension.
- iii. Wind the leg adjuster wheel until 2.5 cm (approximately) gap is formed between the latch and the adjuster wheel.



Notes:

- Final adjustments to TerrainMaster will be made once ladder is erected.
- Final result should be 300mm +/- 15mm step height from the ground.
- Screw turn wheel needs to be wound back to original position to lock the legs closed during storage.

## 11. Check Incline & Step Height



Use level bubble to ensure platform ladder is at correct angle, and level to terrain accordingly. Adjust TerrainMaster wheels to ensure platform ladder level.



Ensure there is a 300mm +/-15mm step from ground to first rung.

## 12. Position Platform Ladder

- i. Before standing platform ladder up check for hazards.
- ii. Stand platform ladder up as per instructions.
- iii. Level the platform ladder to the final work position.

## 13. Rear Safety Rail Operation

Always use rear safety rail when working from platform ladder.

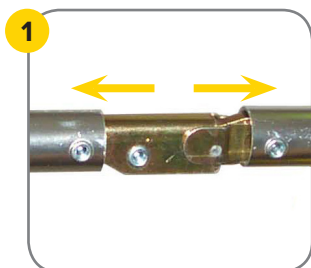

Slide and separate catch.



Lift arms upwards.



Lower arms.



Re-engage Latch.

## 14. Closing Platform Ladder

1



Hold rear deck and raise upwards.

2



Pull deck upwards and let platform come back to upright.

3



Pull deck forward allowing sections to close.



## 15.Storage / Care

- i. It is recommended that platform ladders be stored away from direct sunlight, excessive heat, dampness or exposure to the elements.
- ii. Store the platform ladder in a safe place where it cannot be damaged by vehicles, heavy objects or contaminants.
- iii. Store the platform ladder so it does not become a trip hazard or obstruction.
- iv. Store the platform ladder securely so that it cannot fall and injure people.
- v. When storing platform ladders, give consideration for preventing use by criminals for gaining unauthorised access and ensure children and the general public cannot climb the platform ladder.
- vi. Repairs and maintenance shall be carried out by a competent person who has been qualified by Branach and shall be in accordance with Branach's instructions and procedures. Only use Branach recommended components and fasteners.

## Summary

Ensure work area is safe



**Inspect**  
Before Use



**Level**  
Use level bubble



**Stable**  
TerrainMaster



**Enclosed**  
Rear Safety Rail



## MANUFACTURED BY

### **Branach Manufacturing Pty Ltd**

**a** 1/991 Mountain Highway,  
Boronia, Victoria 3155, Australia  
**w** [branach.com](http://branach.com)

## UK PARTNER

### **KITE Projects**

**a** Littleton Lane, Nr. Sparsholt  
Winchester, Hampshire, SO21 2LS  
**p** 01962 886290  
**e** [sales@kite-projects.co.uk](mailto:sales@kite-projects.co.uk)  
**w** [kite-projects.co.uk](http://kite-projects.co.uk)